

Universal Booster Seat Gabarit Proposals Comparison with Child Restraint Systems

Why comparing CRS ?

- During last IG CRS reference has repeatedly made to Britax Römer KidFix.
- Britax Römer Kidfix is included in the EUNCAP picklist based on the fact that it is a bestseller CRS in EU.
- As reported in IG CRS group for small vehicles e.g. Opel Adam, this seat is to large.
- There are ECE approved CRS for the same child sizes, which fit such small cars, e.g. Takata Picomino Maxi

Since CRS adress different child sizes, as reference CRS position the fitment of Q10 dummy has been used for this comparison.

Britax Römer KidFix



Q10 position is fully extended

Takata Picomino Maxi



Q10 position is 1 notch below maximum extended

- Q10 sits very tight in both

Remember:

- ECE-TRANS-WP29-GRSP-2014-07e, Annex 8, Table 2: Q10 size target 17 Seating height (head tilted forward) < 748+/-9 mm
- ECE-TRANS-WP29-GRSP-2014-07e, Annex 18: Sitting height of child with Stature of 135 cm, 95% : 744 mm

Height

ISO N1042

ISO N1068

Britax Römer KidFix
fully extended

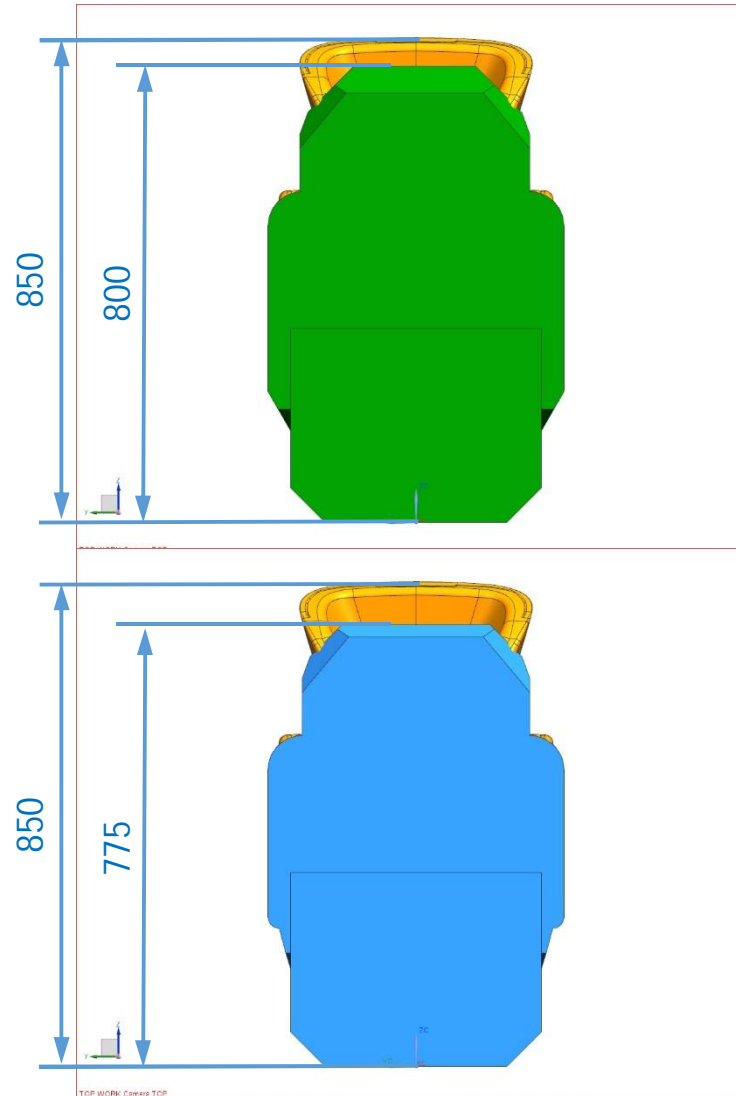

Takata Picomino Maxi
1 notch below maximum extended

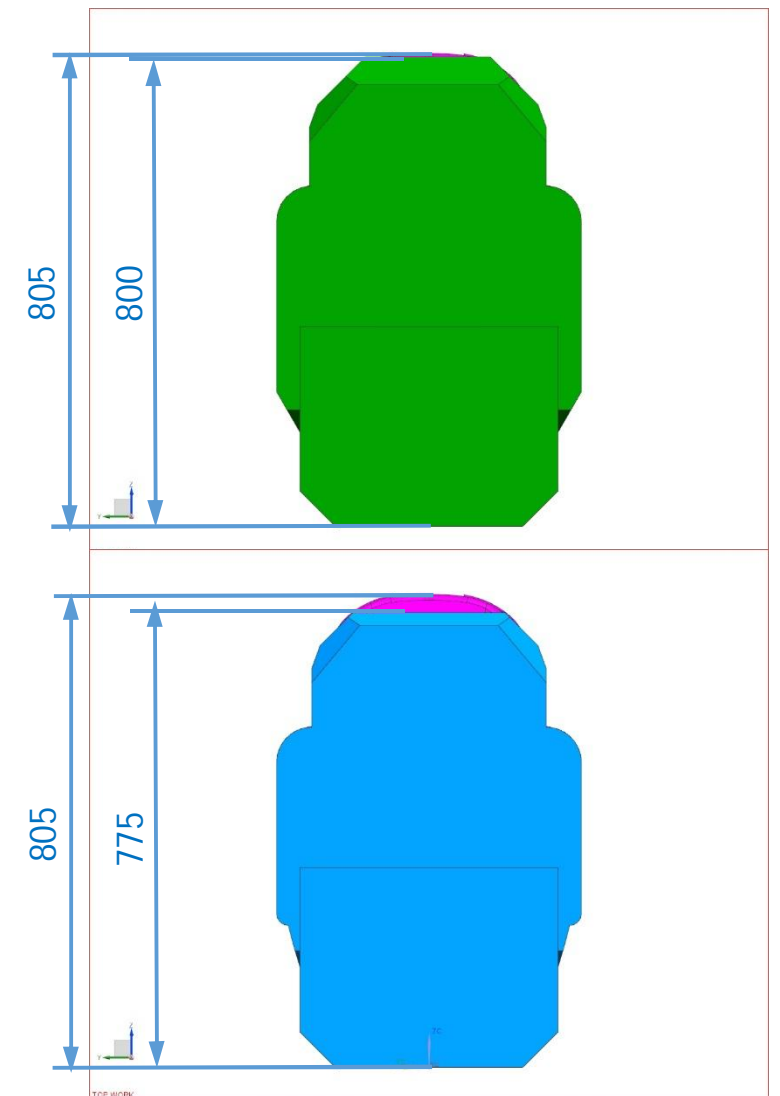

Height

GRSP-55-35

Britax Römer KidFix
fully extended

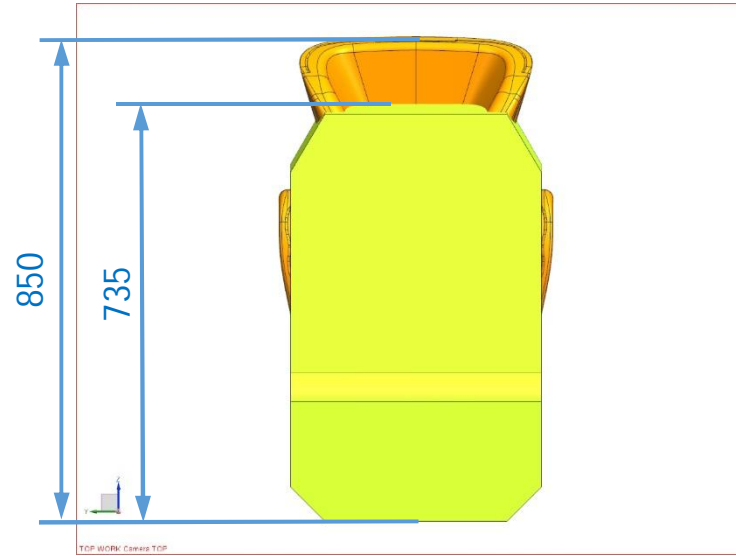

Takata Picomino Maxi
1 notch below maximum extended

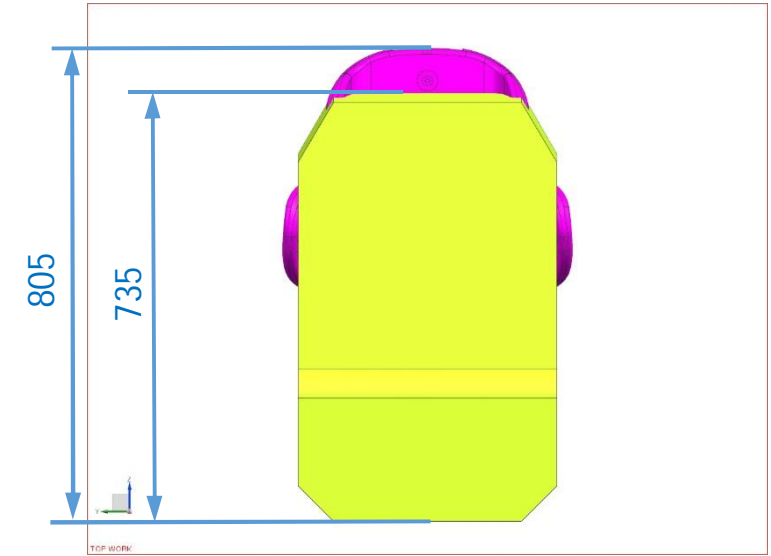

Seat Size measured Fully Extended

fully extended:
850 mm



Q10 Position:
805 mm
fully extended:
820 mm



Correction, April 2015 (Details page 15)

Opel Adam

Britax Römer KidFix



max. extended = 850 mm = NOK

Takata Picomino Maxi

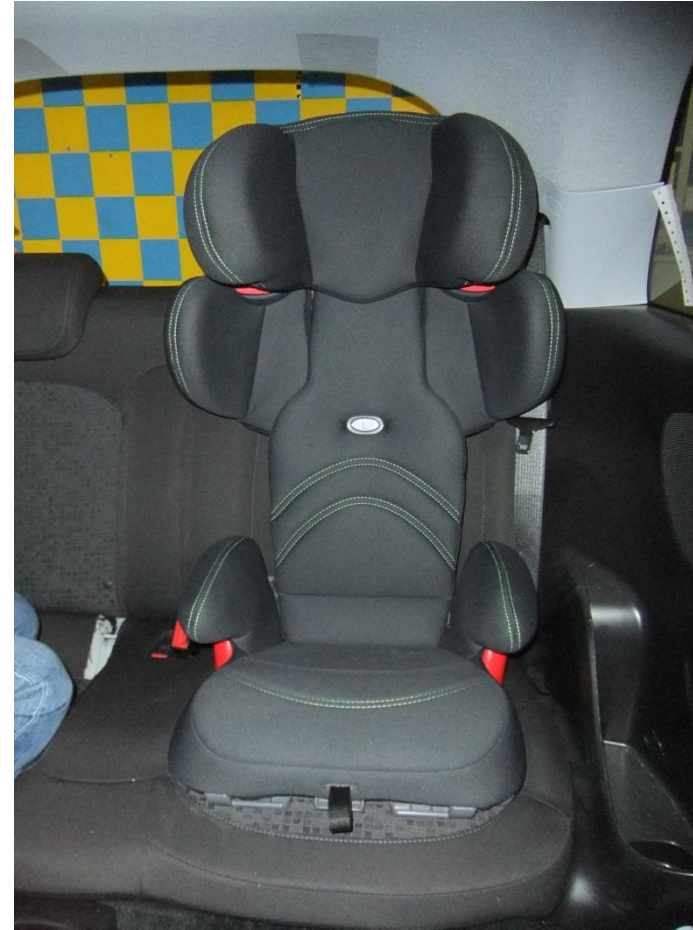

max. extended = 820 mm = OK

Fitment in vehicle is driven by:

- Extended height
- Width and form of the bottom (cushion) of the CRS

Next Pages: Details on CRS Fitment into Gabarits

BRITAX RÖMER KID FIX in ISO N1042

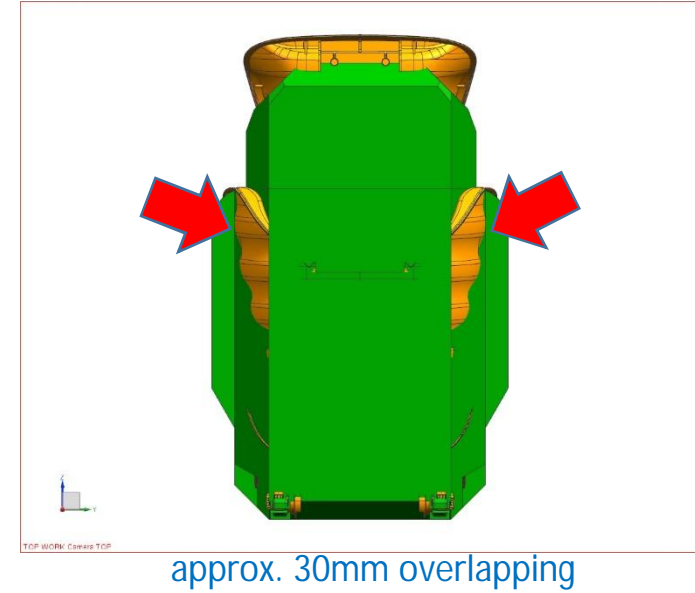
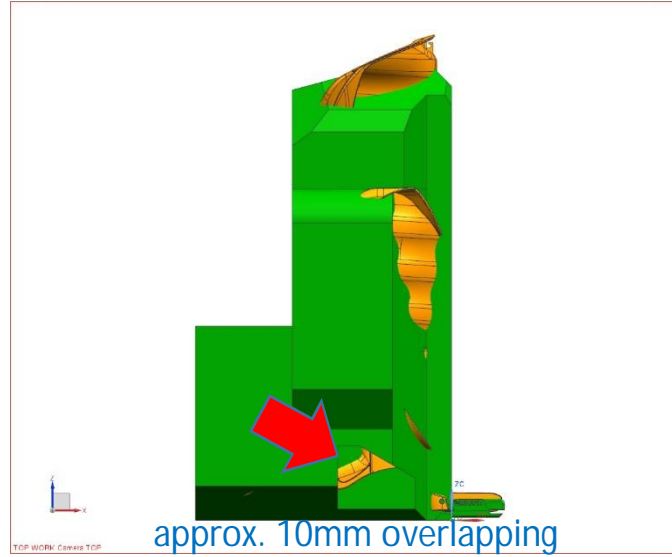
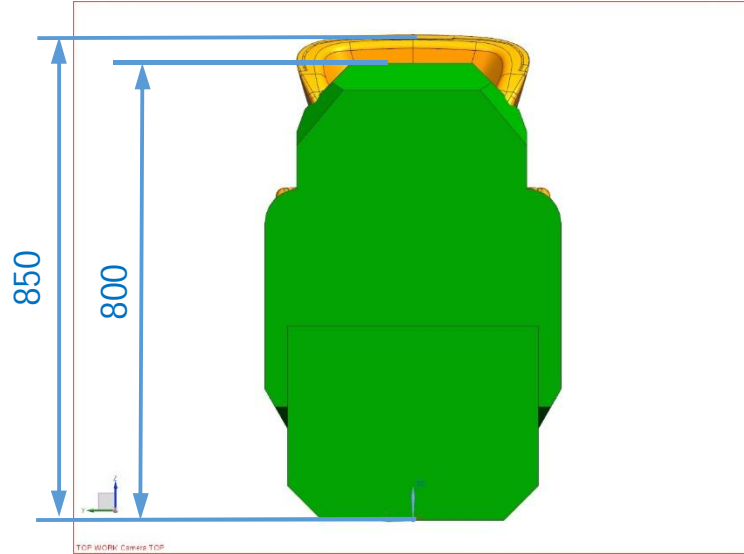

All extended position

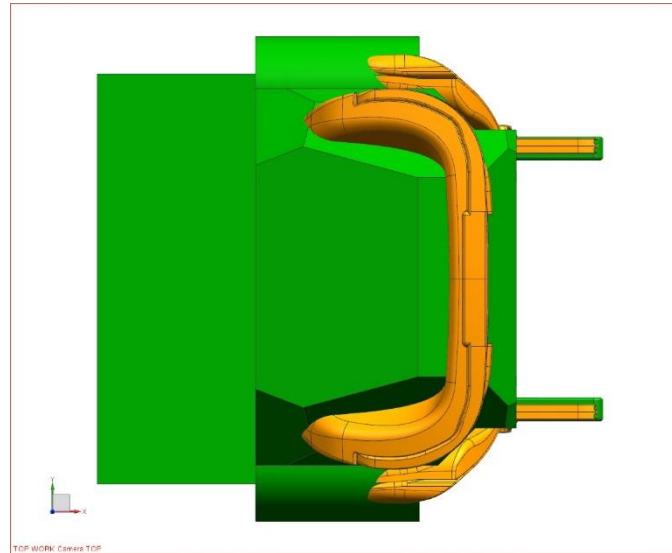

BRITAX RÖMER KID FIX in ISO 1068

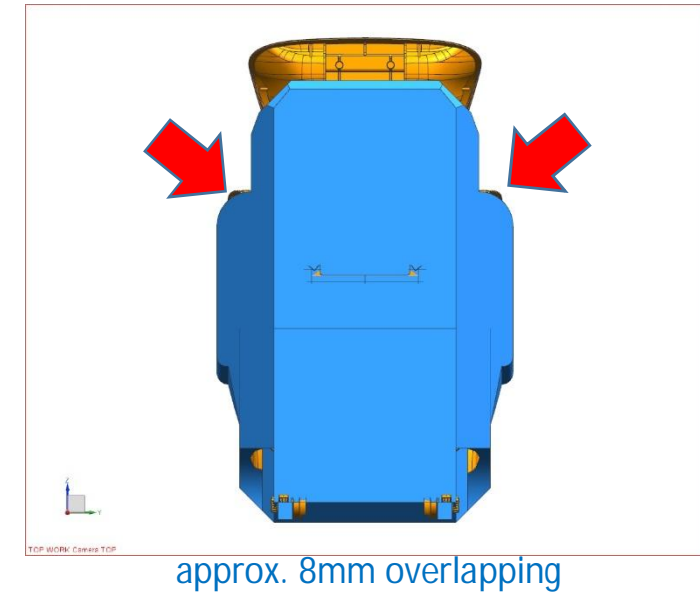
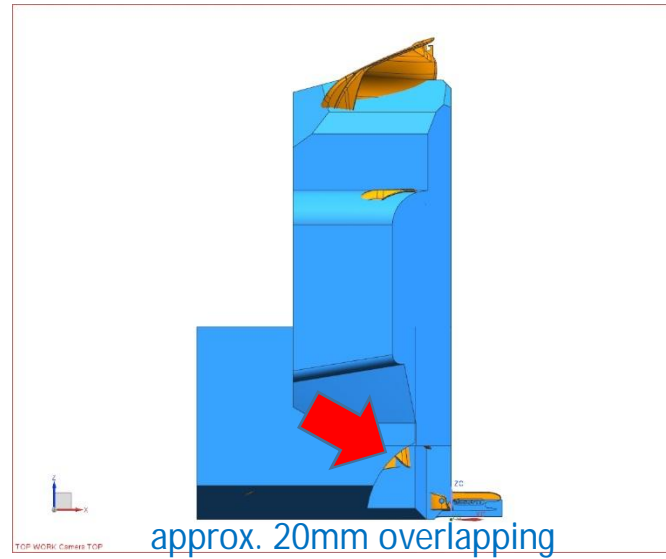
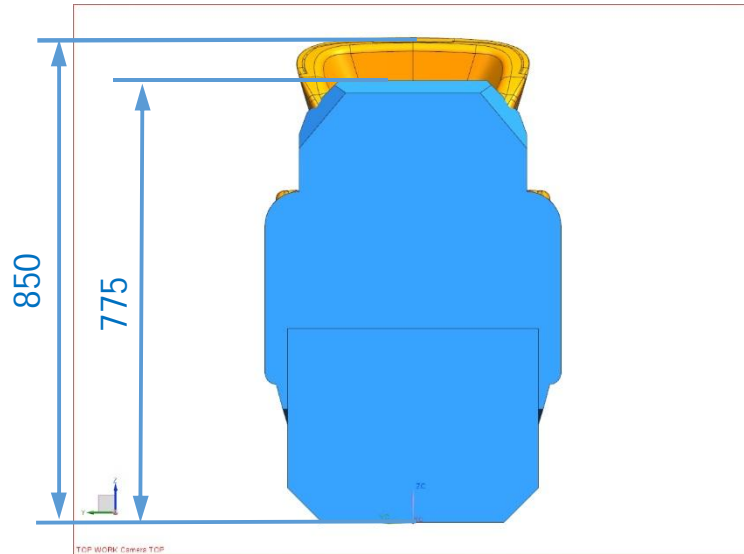

All extended position

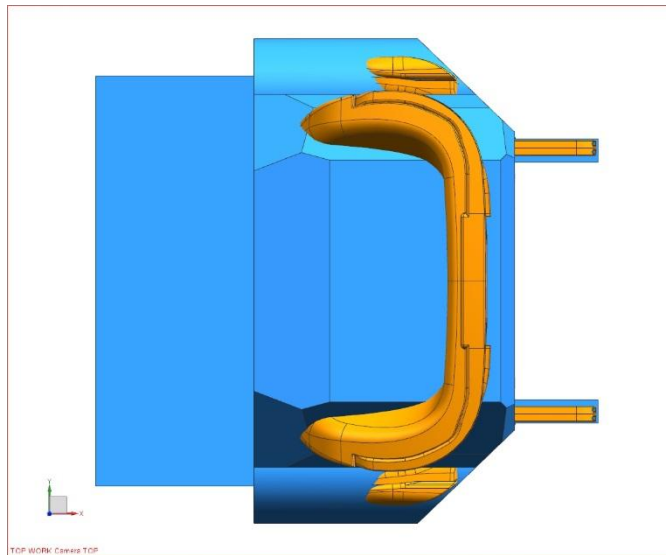

BRITAX RÖMER KID FIX in GRSP-55-35

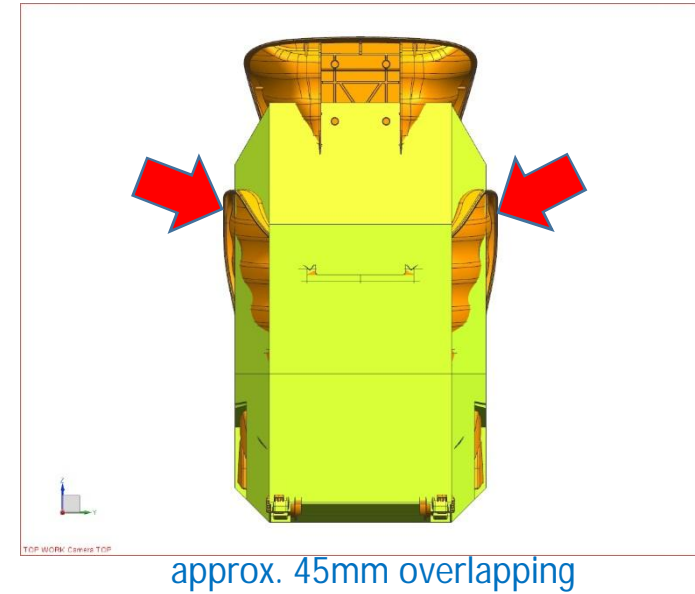
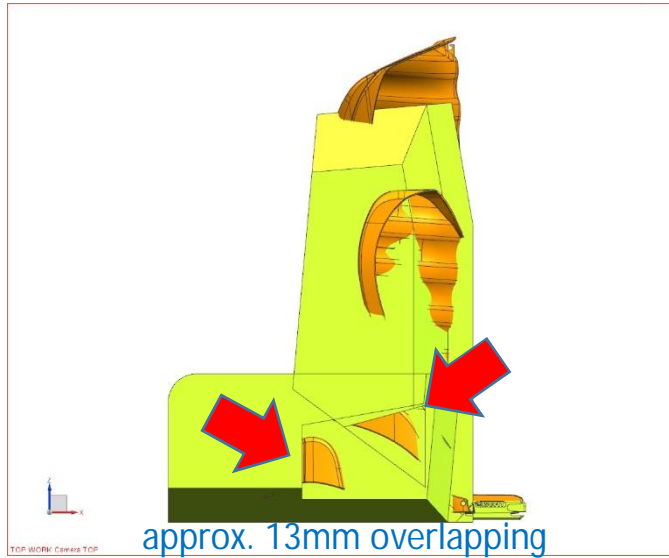
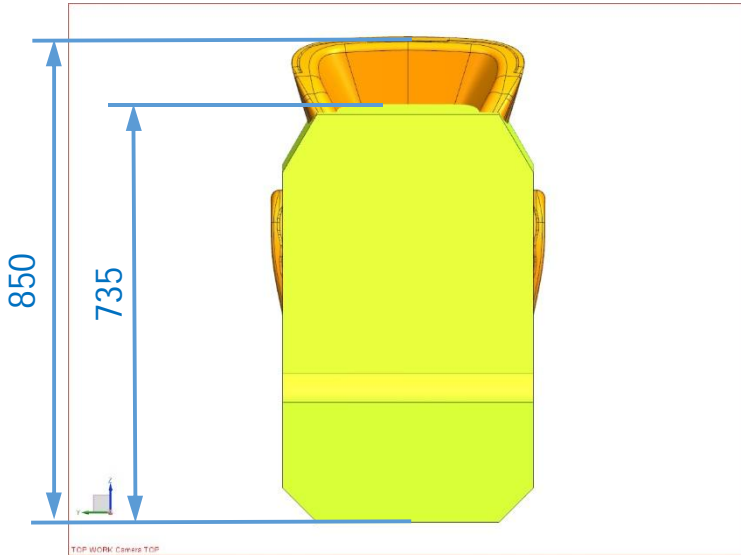

All extended position

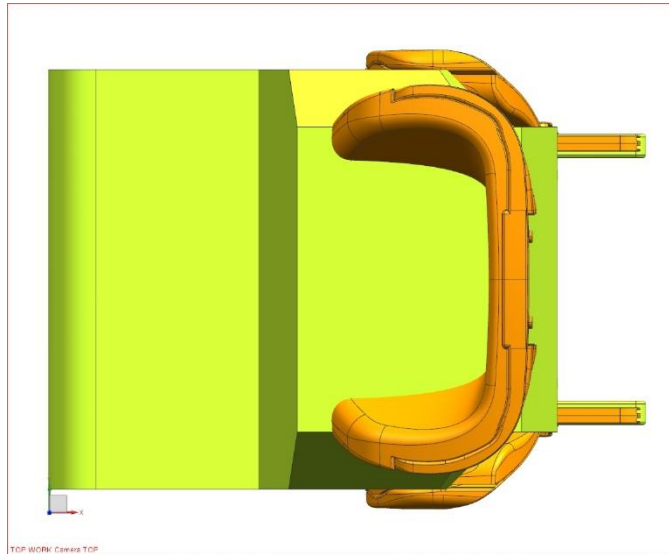

TAKATA PICOMINO MAXI in ISO N1042

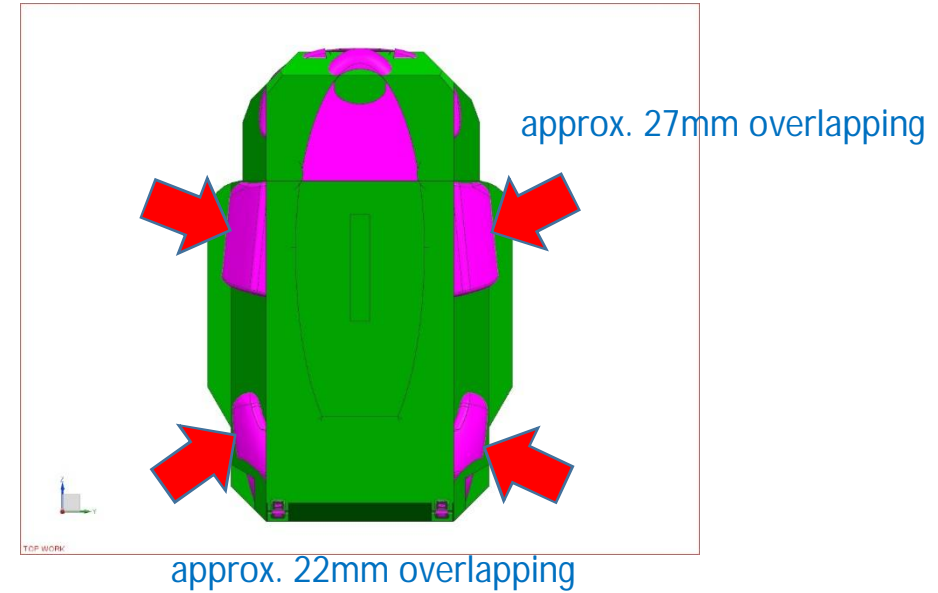
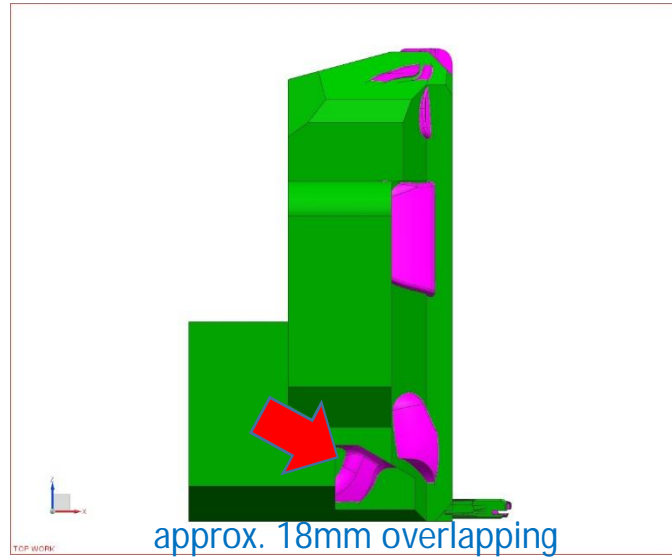
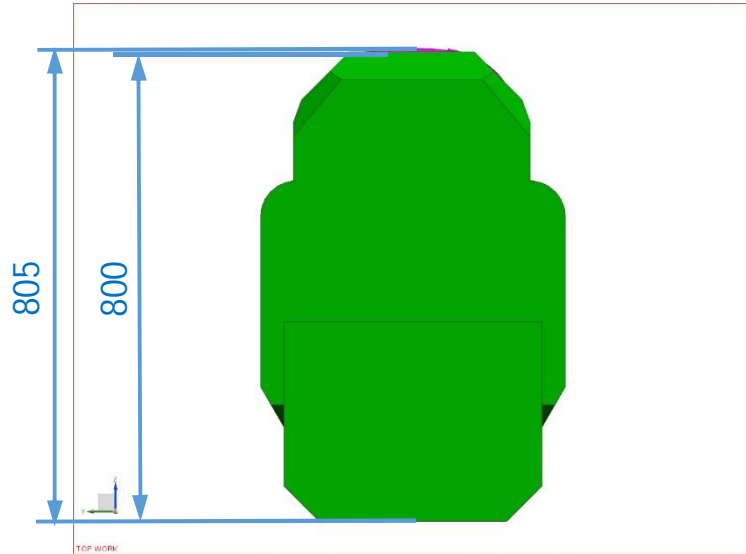

Maxi is in Q10 position:
– 1 notch below maximum extended

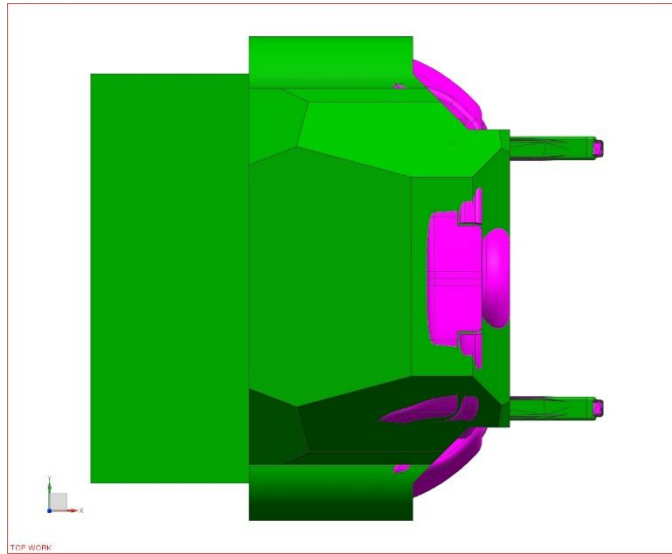

TAKATA PICOMINO MAXI in ISO N1068

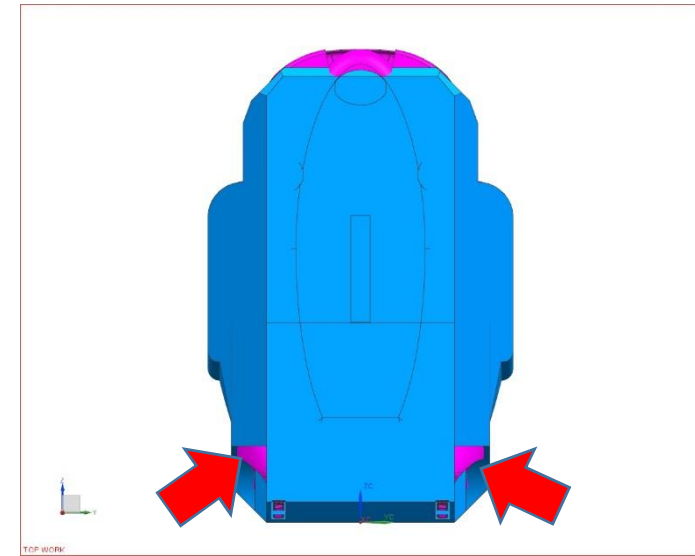
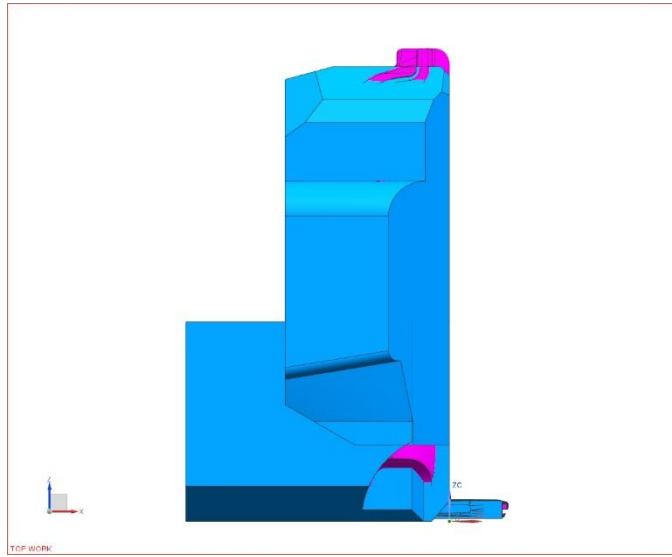
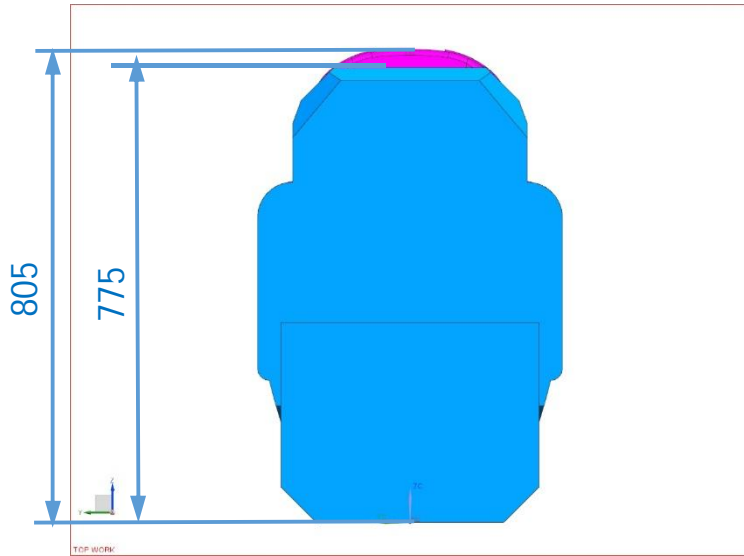

approx. 32mm overlapping

Maxi is in Q10 position:
– 1 notch below maximum extended

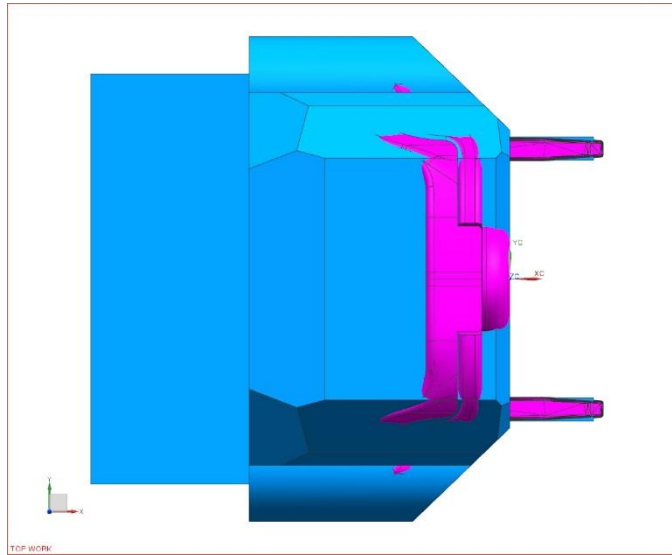

TAKATA PICOMINO MAXI in GRSP-55-35

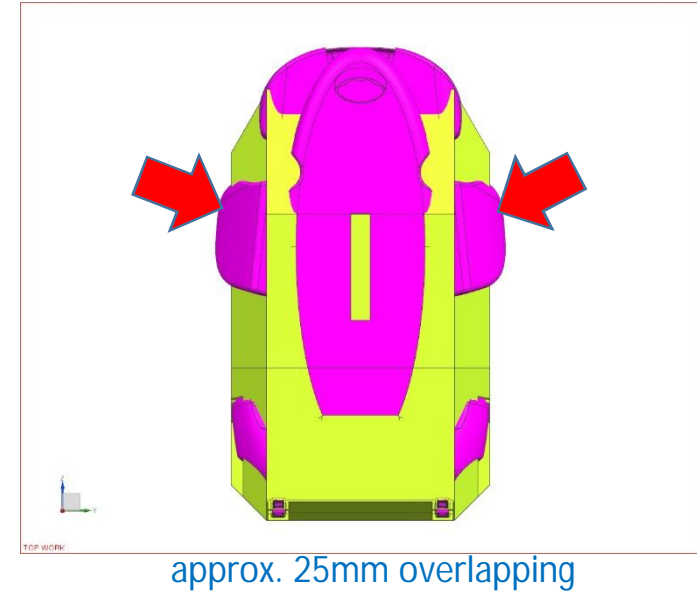
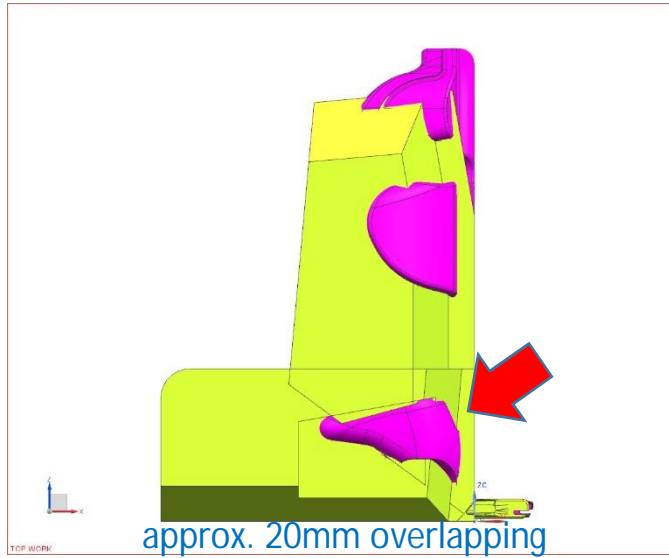
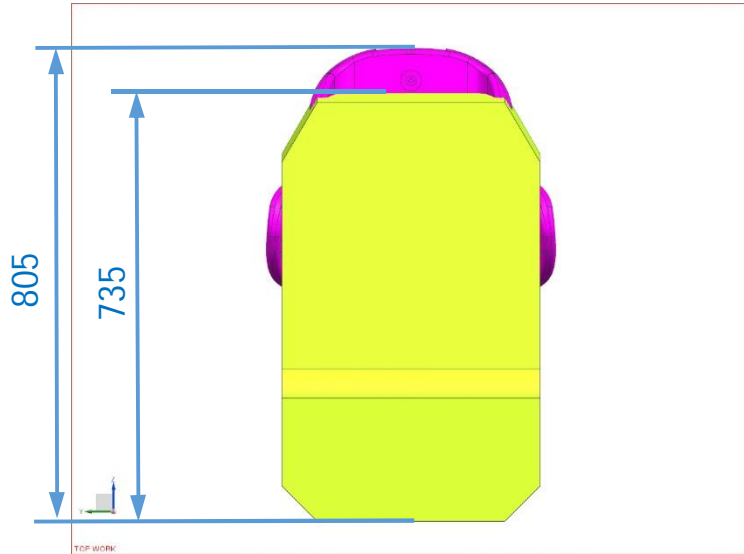

Maxi is in Q10 position
– 1 notch below maximum extended

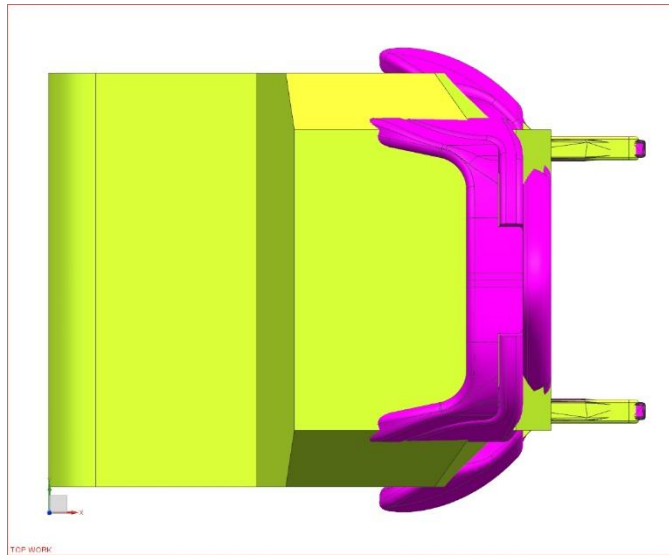

Next Pages: Details on CRS Size

Non extended

- For non extended both have same Size

Britax Römer KidFix



Takata Picomino Maxi



Fully extended

- For fully extended Britax is 30 mm higher
- Britax is 70 mm wider for cushion width
- Takata is 15 mm wider for width of side wings
- Britax is 5 mm wider for headrest width

Please Note: While picture shows Britax fully extended, Takata is shown in non extended position (Q3 position). In this Position the Takata seat has a width of 450 mm for the side wings. The width raises, when the seat is extended. For the Q10 position the width is 495 mm.

Britax Römer KidFix



Takata Picomino Maxi



Cushion Depth

- Takata has 10 mm more cushion depth

Britax Römer KidFix



Takata Picomino Maxi



Cushion Height without (with) pressure*

- Britax has 37 mm more cushion height when measured without pressure
- Britax has 18 mm more cushion height when measured with* pressure

* Pressure = Weight of Q10

Britax Römer KidFix



Takata Picomino Maxi

