

# Universal Booster Seat Gabarit Proposals Comparison with Child Restraint Systems

## Why comparing CRS ?

- During last IG CRS reference has repeatedly made to Britax Römer KidFix.
- Britax Römer Kidfix is included in the EUNCAP picklist based on the fact that it is a bestseller CRS in EU.
- As reported in IG CRS group for small vehicles e.g. Opel Adam, this seat is too large.
- There are ECE approved CRS for the same child sizes, which fit such small cars, e.g. Takata Picomino Maxi

Since CRS address different child sizes, as reference CRS position the fitment of Q10 dummy has been used for this comparison.

## Britax Römer KidFix



Q10 position is fully extended

## Takata Picomino Maxi



Q10 position is 1 notch below maximum extended

- Q10 sits very tight in both

Remember:

- ECE-TRANS-WP29-GRSP-2014-07e, Annex 8, Table 2: Q10 size target 17 Seating height (head tilted forward) < 748+/-9 mm
- ECE-TRANS-WP29-GRSP-2014-07e, Annex 18: Sitting height of child with Stature of 135 cm, 95% : 744 mm

# Height

ISO N1042

ISO N1068

Britax Römer KidFix  
fully extended

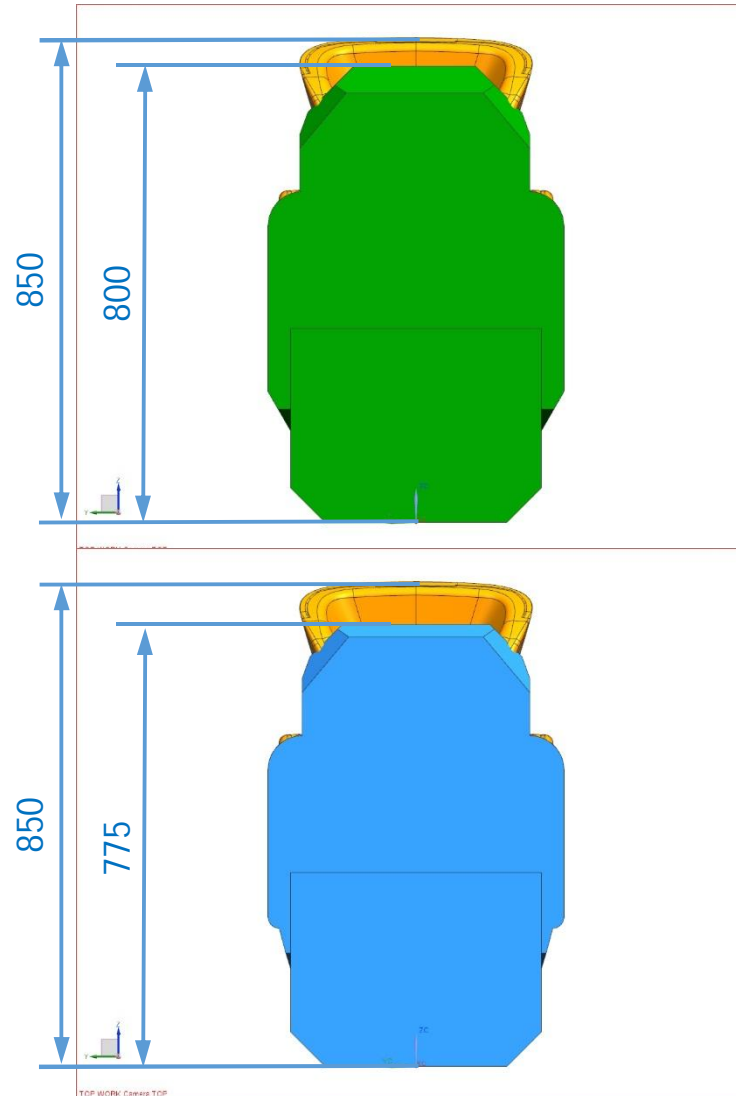

Takata Picomino Maxi  
1 notch below maximum extended

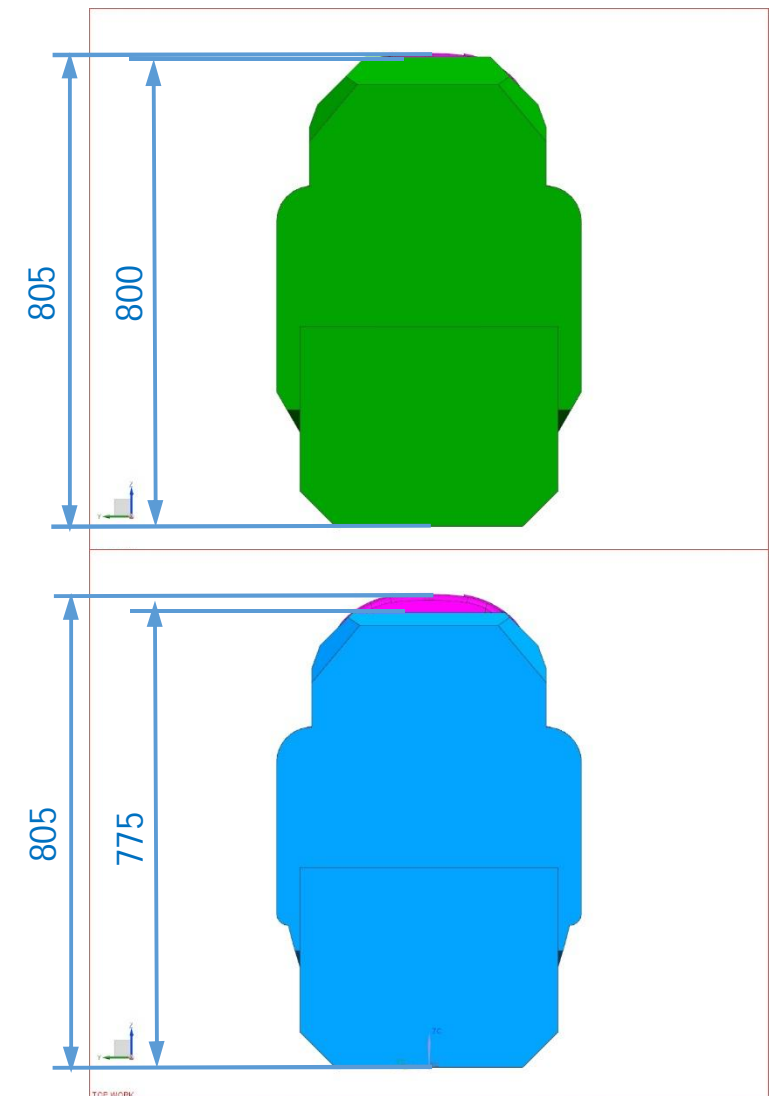

# Height

## GRSP-55-35

Britax Römer KidFix  
fully extended

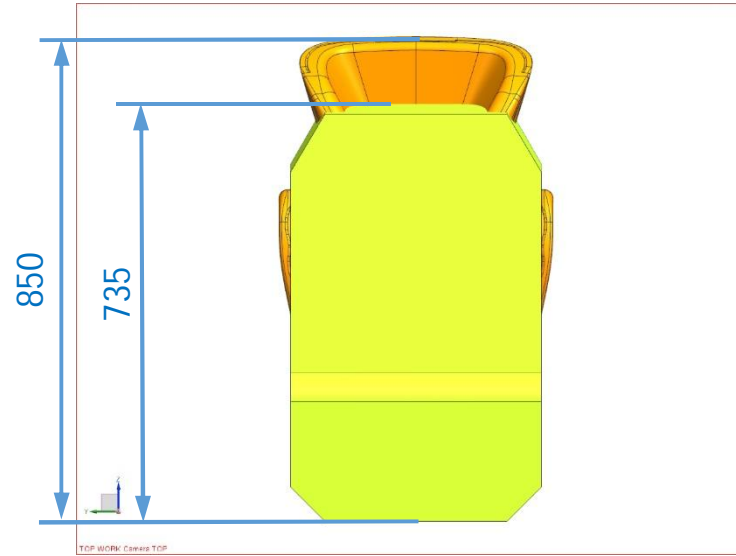

Takata Picomino Maxi  
1 notch below maximum extended

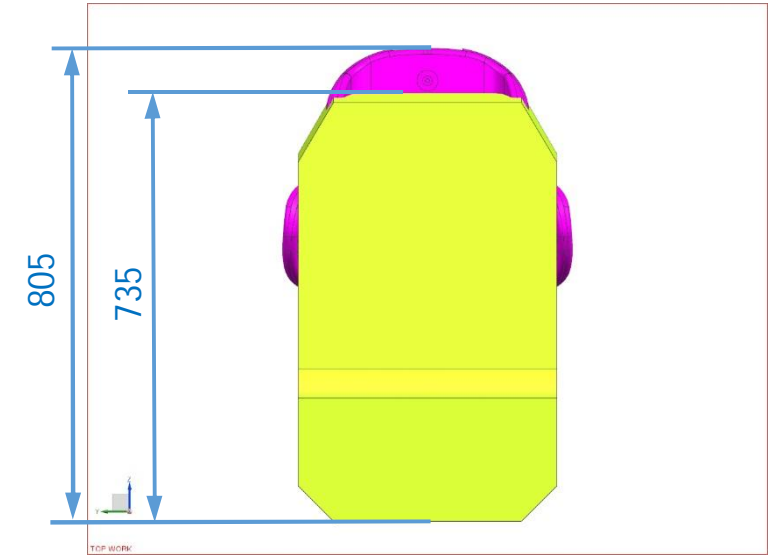

# Seat Size measured Fully Extended

fully extended:  
850 mm



Q10 Position:  
805 mm  
fully extended:  
820 mm





# Opel Adam

## Britax Römer KidFix



max. extended = 850 mm = NOK

## Takata Picomino Maxi

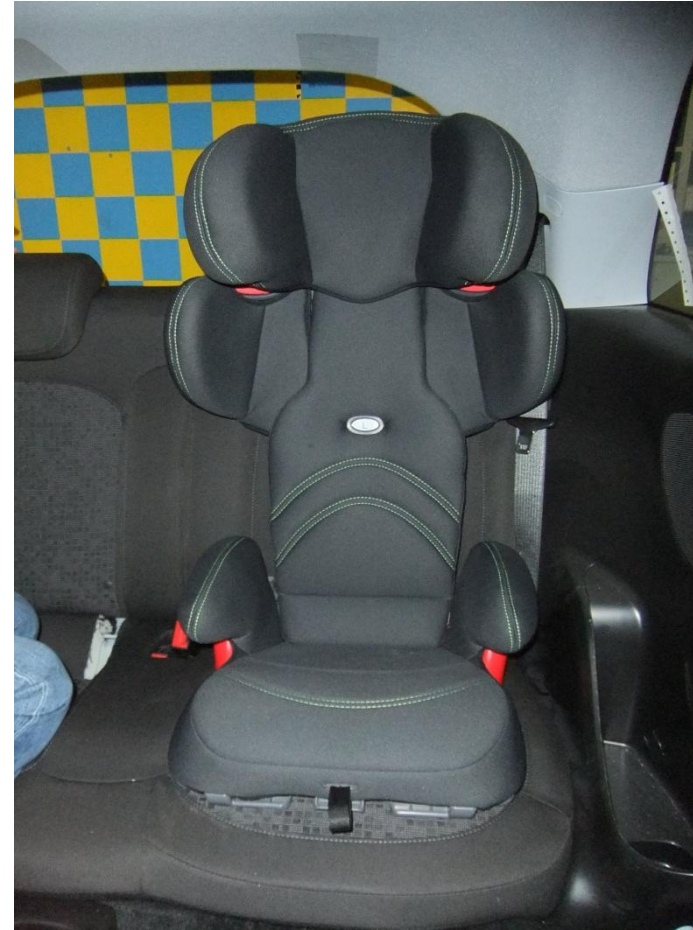

max. extended = 820 mm = OK

Fitment in vehicle is driven by:

- Extended height
- Width and form of the bottom (cushion) of the CRS

# Next Pages: Details on CRS Fitment into Gabarits

# BRITAX RÖMER KID FIX in ISO N1042

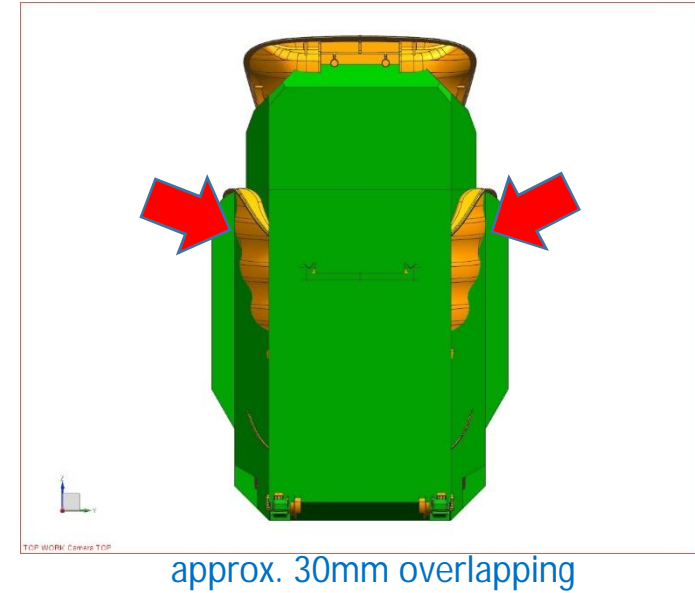
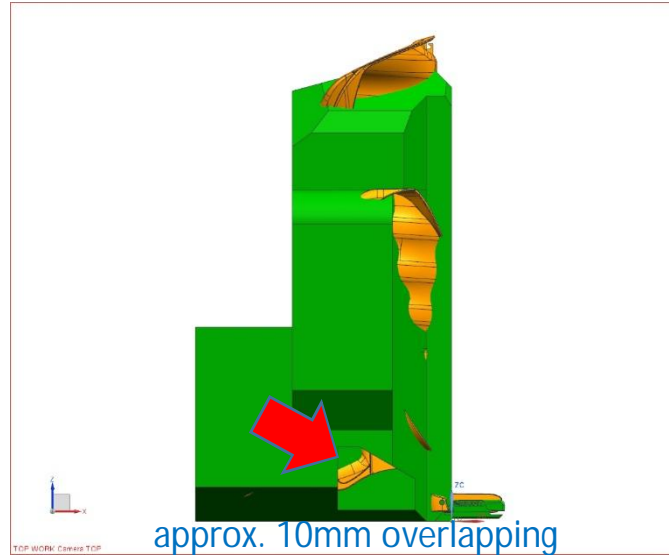
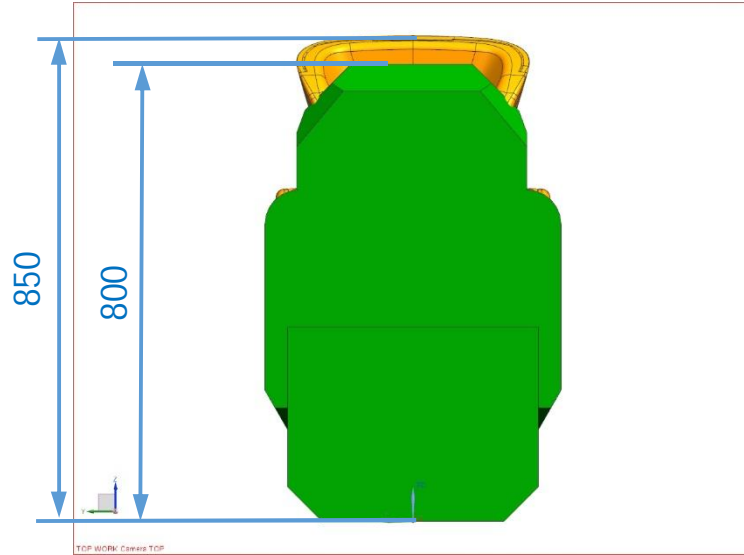

All extended position

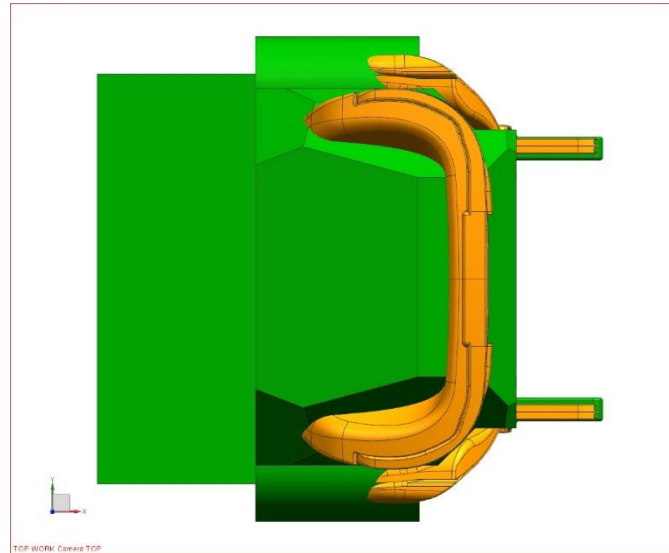

# BRITAX RÖMER KID FIX in ISO 1068

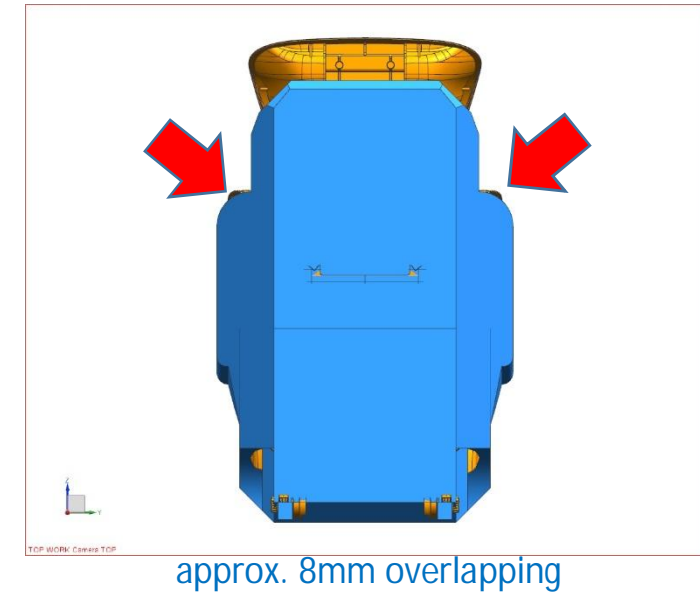
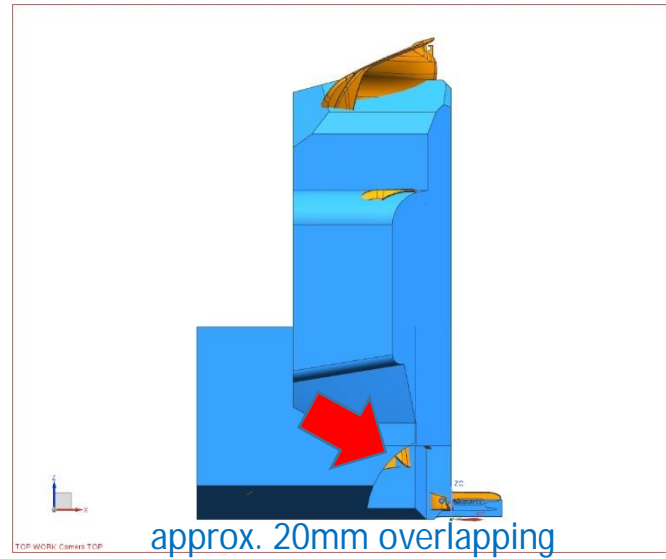
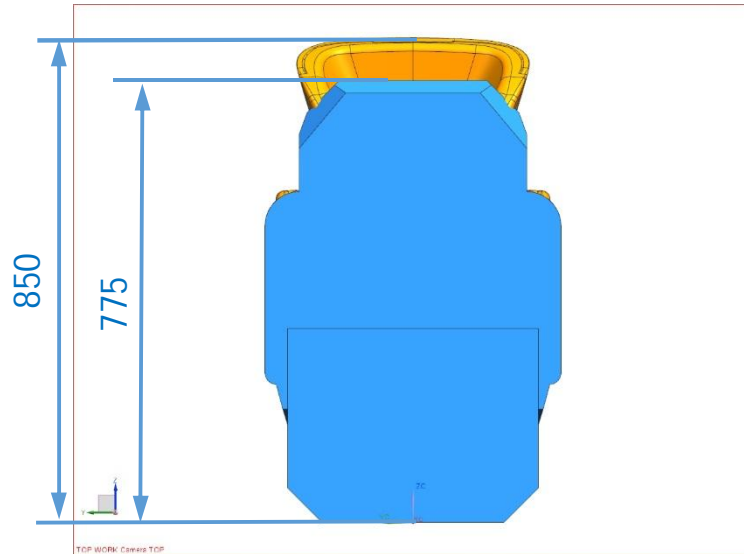

All extended position

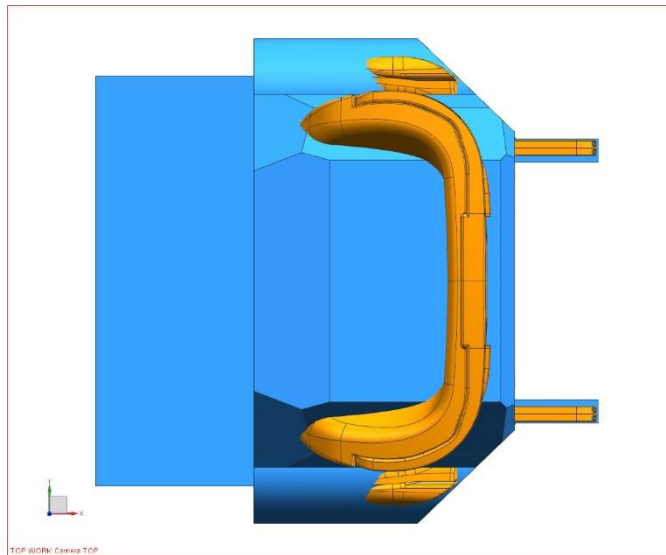



# BRITAX RÖMER KID FIX in GRSP-55-35

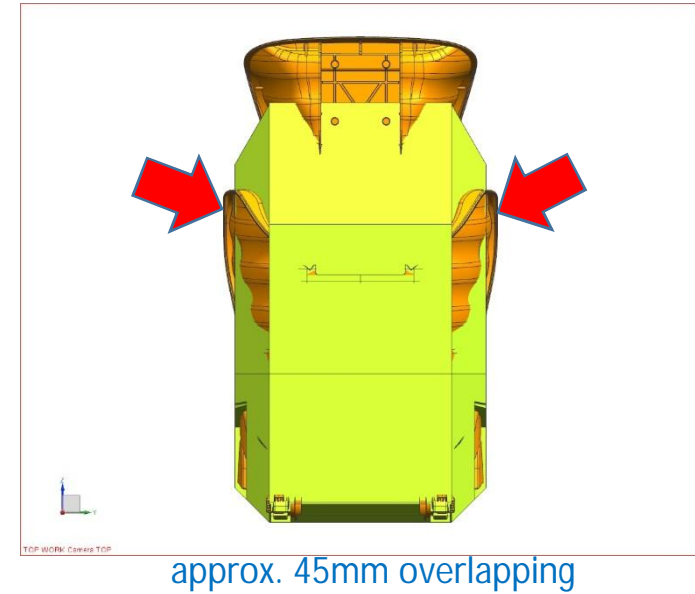
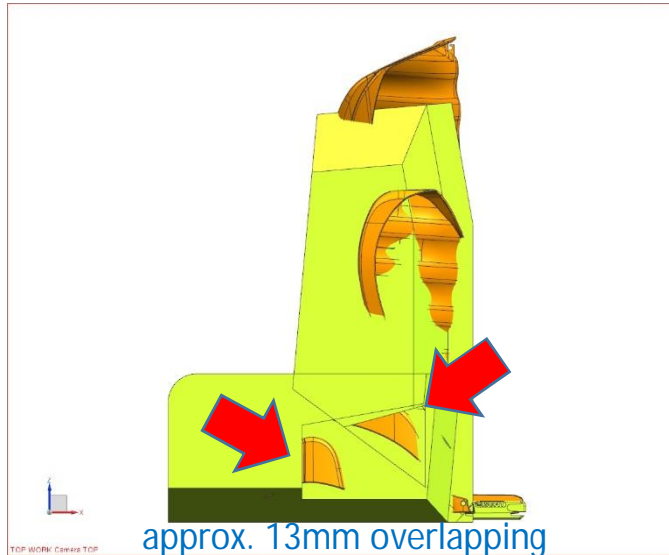
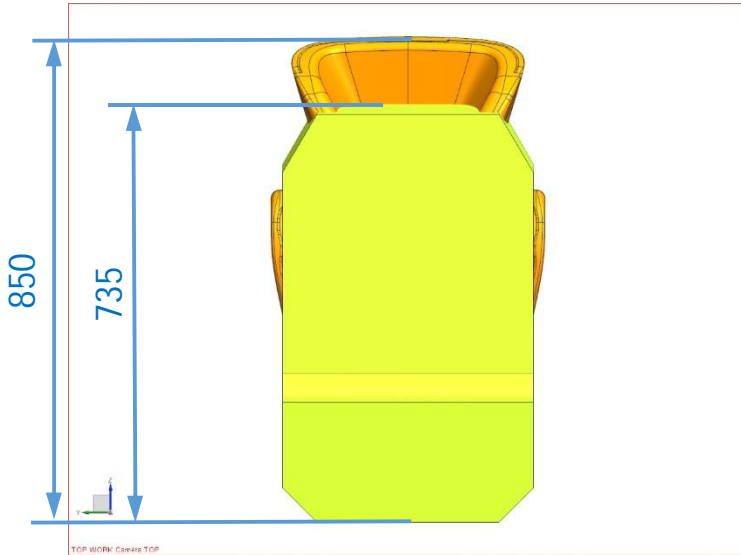

All extended position

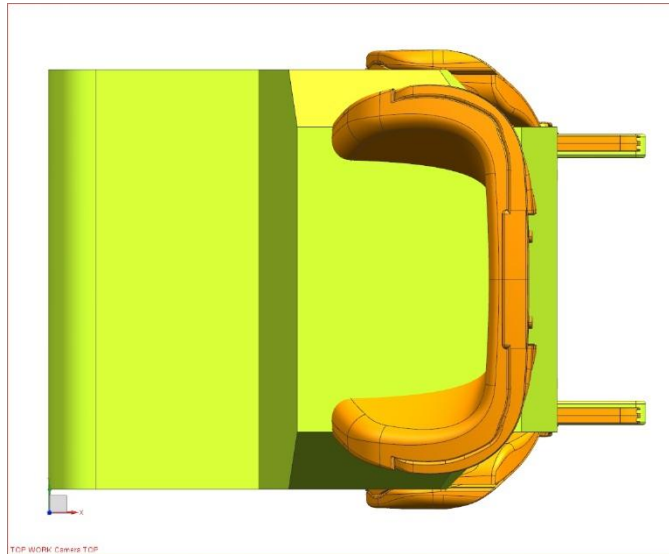

# TAKATA PICOMINO MAXI in ISO N1042

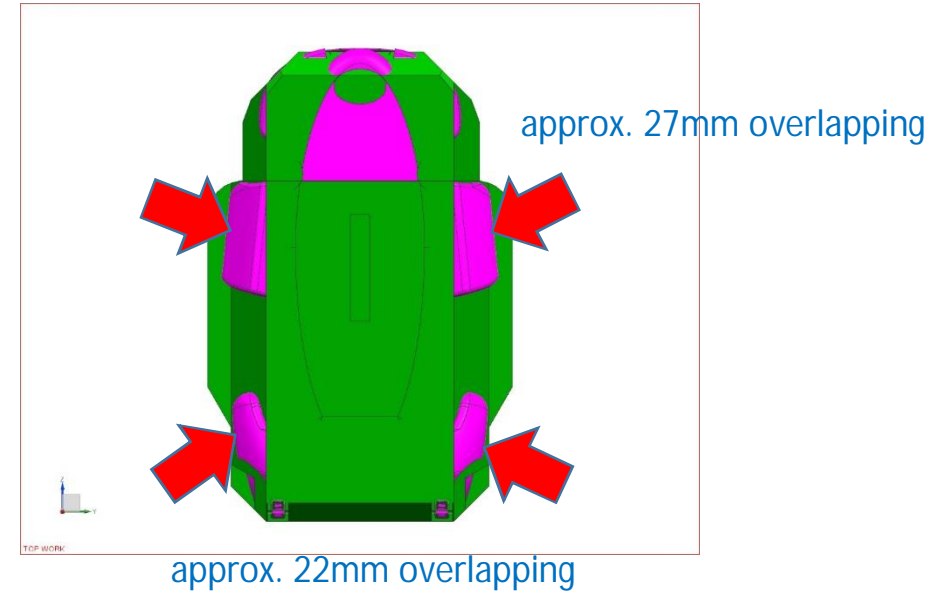
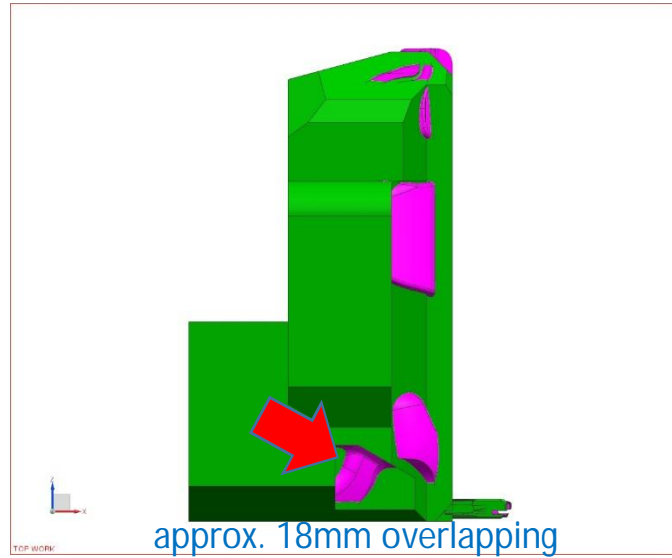
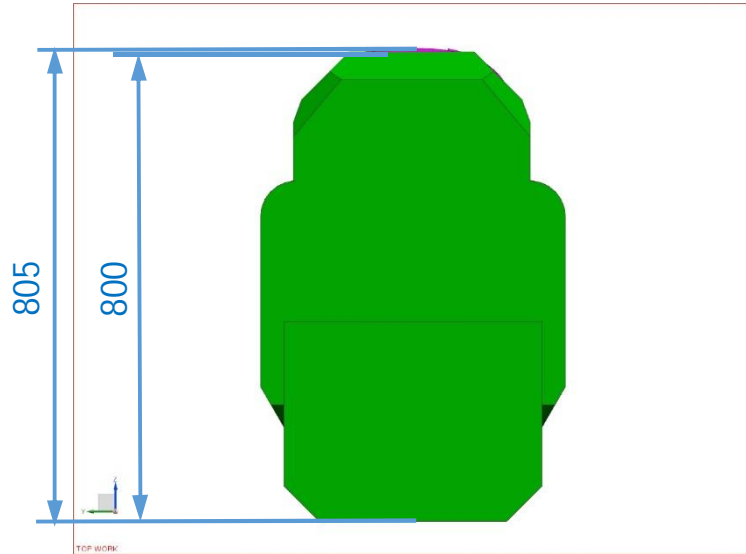

Maxi is in Q10 position:  
– 1 notch below maximum extended

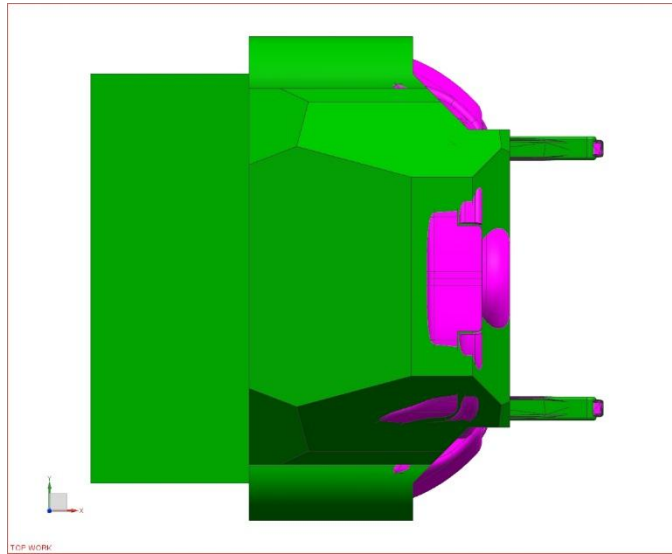

# TAKATA PICOMINO MAXI in ISO N1068

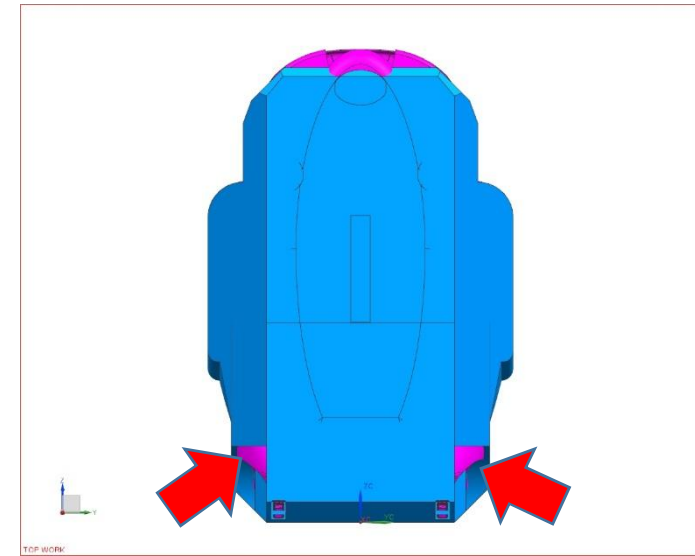
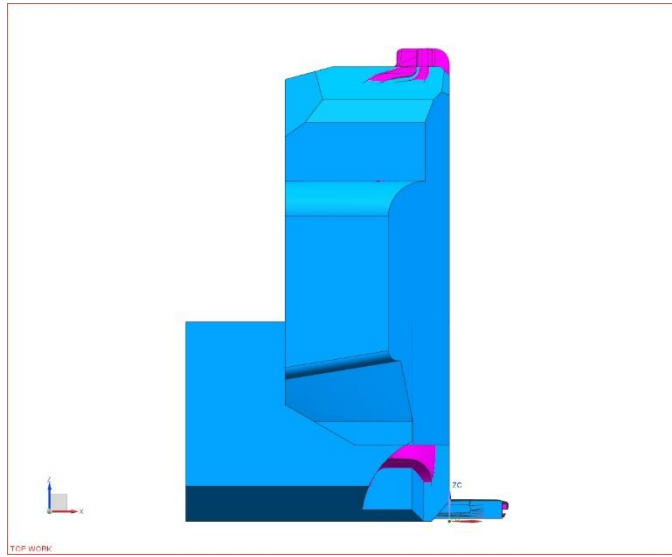
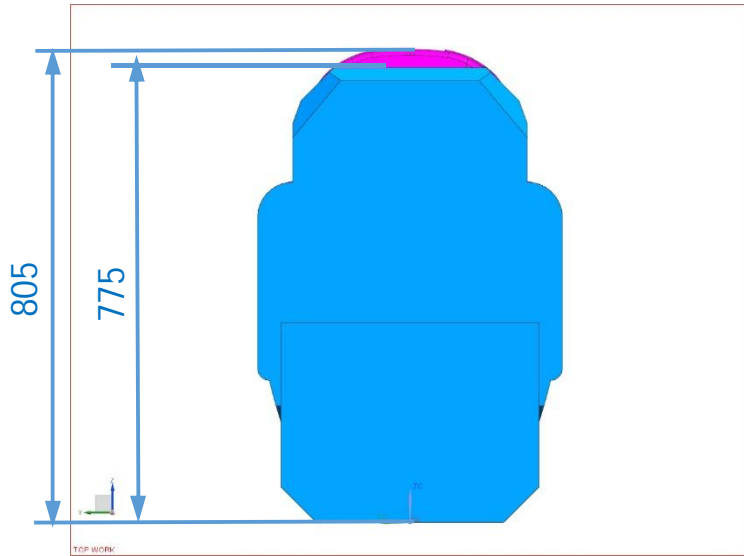

approx. 32mm overlapping

Maxi is in Q10 position:  
– 1 notch below maximum extended

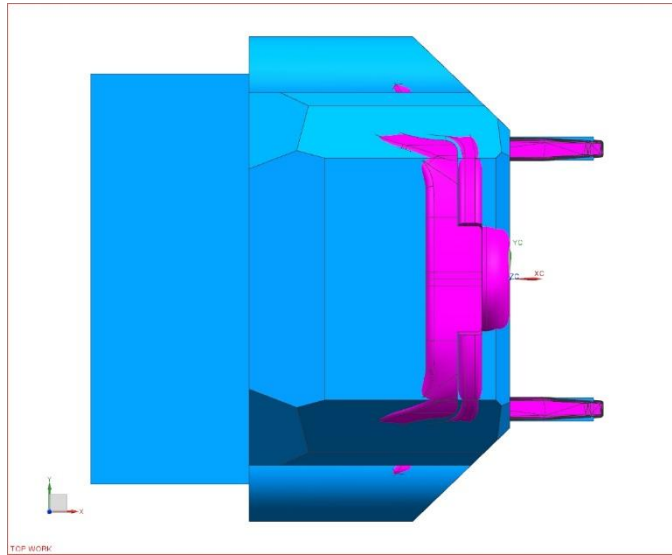

# TAKATA PICOMINO MAXI in GRSP-55-35

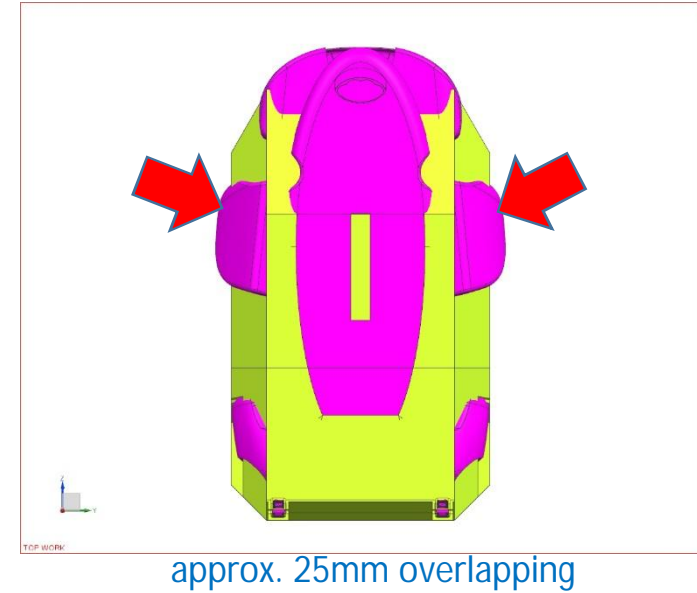
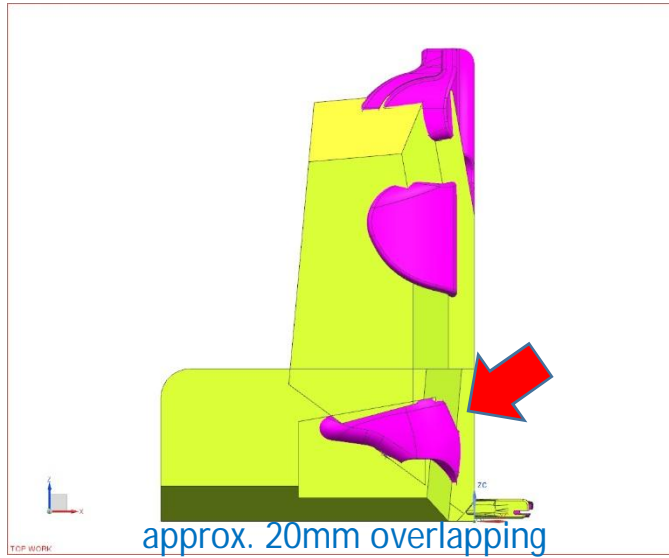
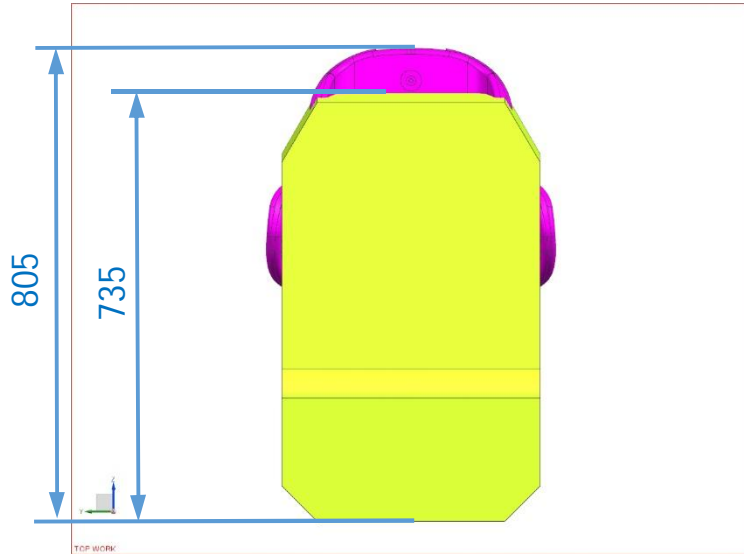

Maxi is in Q10 position  
– 1 notch below maximum extended

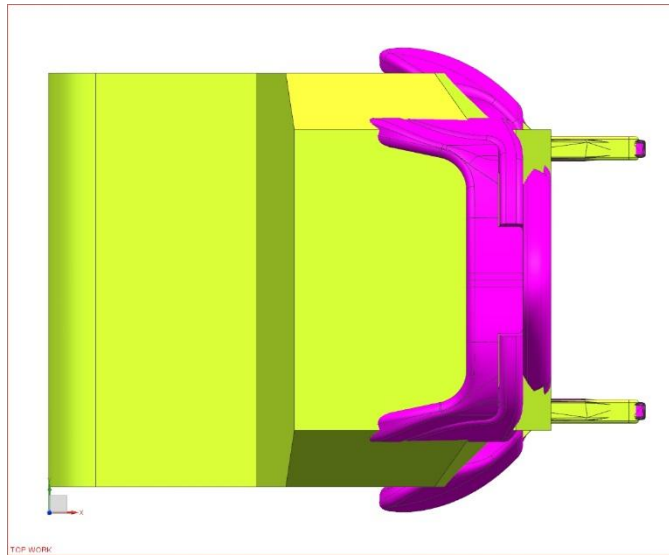

# Next Pages: Details on CRS Size

## Non extended

- For non extended both have same Size

### Britax Römer KidFix



### Takata Picomino Maxi





## Fully extended

- For fully extended Britax is 30 mm higher
- Britax is 70 mm wider for cushion width
- Britax is 30 mm wider for width of side wings
- Britax is 5 mm wider for headrest width

### Britax Römer KidFix



### Takata Picomino Maxi





## Cushion Depth

- Takata has 10 mm more cushion depth

### Britax Römer KidFix



### Takata Picomino Maxi





## Cushion Height without (with) pressure\*

- Britax has 37 mm more cushion height when measured without pressure
- Britax has 18 mm more cushion height when measured with\* pressure

\* Pressure = Weight of Q10

### Britax Römer KidFix



### Takata Picomino Maxi

